



**MANUAL**

INSTRUCTIONS | OPERATION

**DF9**  
**Individual Support**  
**For Module**

MAY/25



**smar**  
Technology Company

# DF9

Individual Support for Module

Consult our  
subsidiary



Rua Dr. Antônio Furlan Junior, 1028 - Sertãozinho, SP - CEP: 14170-480  
insales@smar.com.br | +55 (16) 3946-3599 | www.smar.com

© Copyright 2025, Nova Smar S/A. All rights reserved. May 2025.  
Specifications and information are subject to change.  
Updated addresses are available on our website.

**smar**  
Technology Company



## DF9 – INDIVIDUAL SUPPORT FOR MODULE

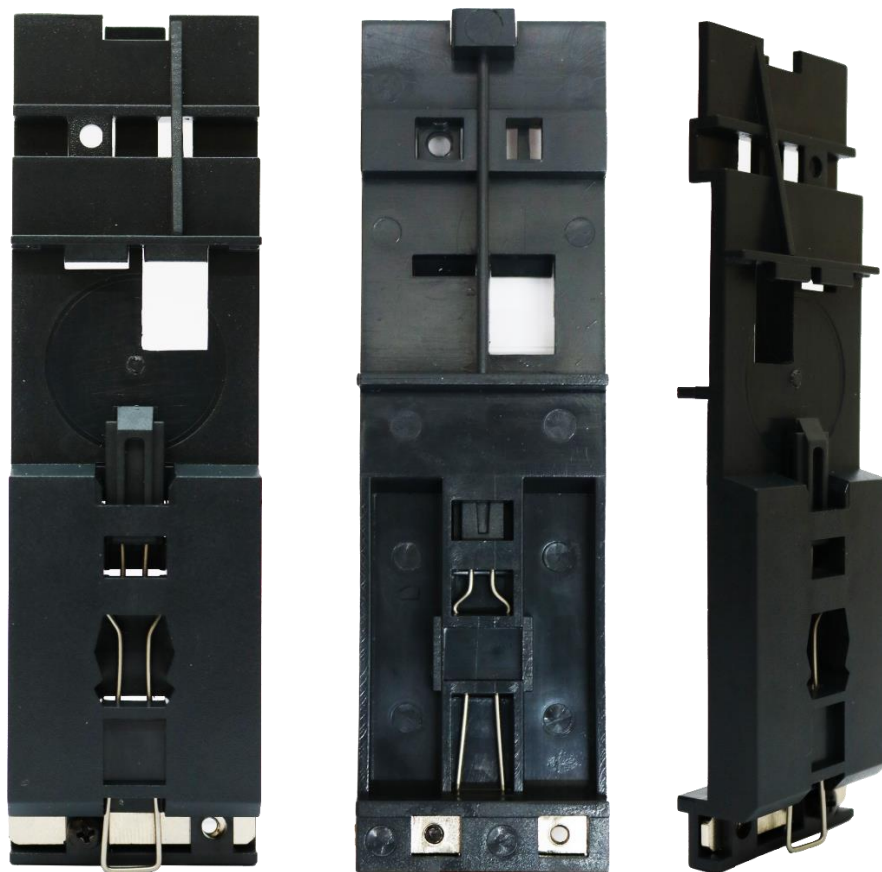

Figure1 – DF9 Module – Rear, Front and Side Details

### Description

The DF9 bracket is an accessory of the DFI302 line and is used to install modules individually. The power to the module must be supplied externally.

Modules that do not depend on the IMB bus, but need to be placed on the DIN rail, can be installed in the DF9, such as the Enet710, ICS2.0P, AM01P and CIV200P.

The DF9 is supplied together with compatible modules. If the user uses the rack, it can be discarded.

DF9 compatible modules	
Code	Description
AM01P	Auto/Manual Transfer Station
CIV200P	Current/Voltage Converter
DF47-12	Intrinsic Safety Barrier
DF47-17	Intrinsic Safety Barrier
DF49/PSI302P-2	Fieldbus Power Supply Impedance with 2 ports
DF52/PS302	Power Supply for Fieldbus 90-264 Vac
DF53/PSI302P-4	Fieldbus Power Supply Impedance with 4 ports
DF58/SI700	EIA-232/ EIA-485 Interface
DF60/PS302P	Power Supply for Fieldbus 20-30 Vdc
ENET-710	MODBUS / CDBUS TCP 10/100 Base-T Ethernet Module
ICS2.0P	EIA-232/EIA-485 Serial Converter Interface
IS400P	Power Distributor and Isolator
OPT700	Serial to Fiber Optic Converter

## Dimensional Drawing

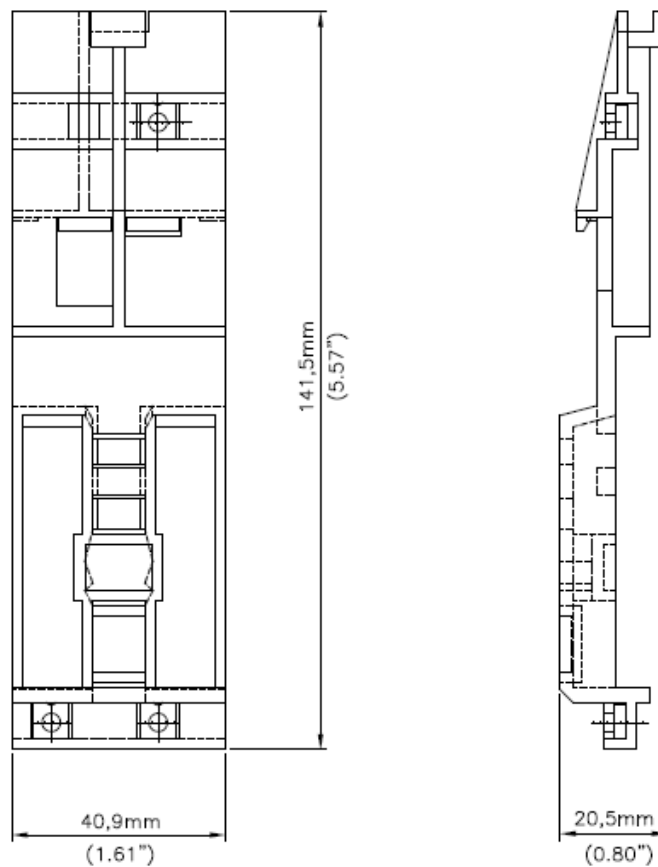

**Figure 2 – Dimensional drawing**

## Installing Modules in DF9

Follow the steps below:

- Attach the DF9 onto the DIN rail;
- Attach the top of the module (with a 45° inclination) to the module support located on the upper part of the DF9.
- Push the module to lock it into place;
- Next, fix the module to the DF9 using a screwdriver, and fasten the fixation screw at the bottom of the module.